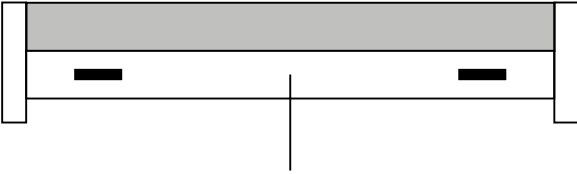
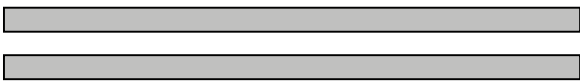
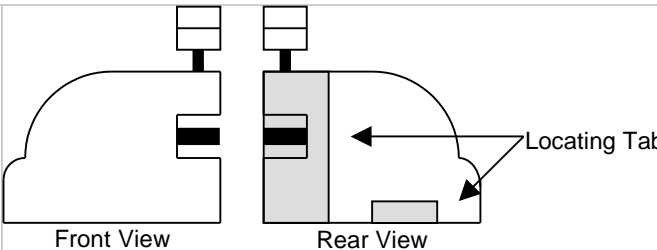

600 - Commercial Roller Fly Screen – Fitting Instructions

Your screen has been pre-cut to the dimensions provided by you when you ordered. Please follow the instructions for fitting. If you need assistance call 01628 481919

Parts list

 <p>Header Cassette x 1</p>	 <p>Side Guides x 2</p>
<p>4 x No 6 1" Silver Screws + Yellow Plugs (For Securing Header cassette)</p> <p>2 or more face fitting brackets (if the face fitting option has been selected)</p>	<p>1 pack of Black Screws + Grey Plugs (For Securing Side Guides)</p>
	 <p>Front View Rear View</p> <p>Locating Tabs</p> <p>Locking Mechanism x 2 or Magnetic Closing Channel with No 6 3/8" screws as ordered</p>

Instructions

Please check that all parts are enclosed.

To fit the Roller Screen you will require the following tools:

- Power drill.
- Posidrive 2 screwdriver
- 2.5mm Metal drill bit
- 5mm masonry drill bit (for the yellow rawl plugs)
- 6mm masonry drill bit (for the grey rawl plugs)
- Tape measure

Follow the figures and notes below, fitting the Header Cassette first followed by the Side Guides.

Fitting the Header Cassette - Fig 1.

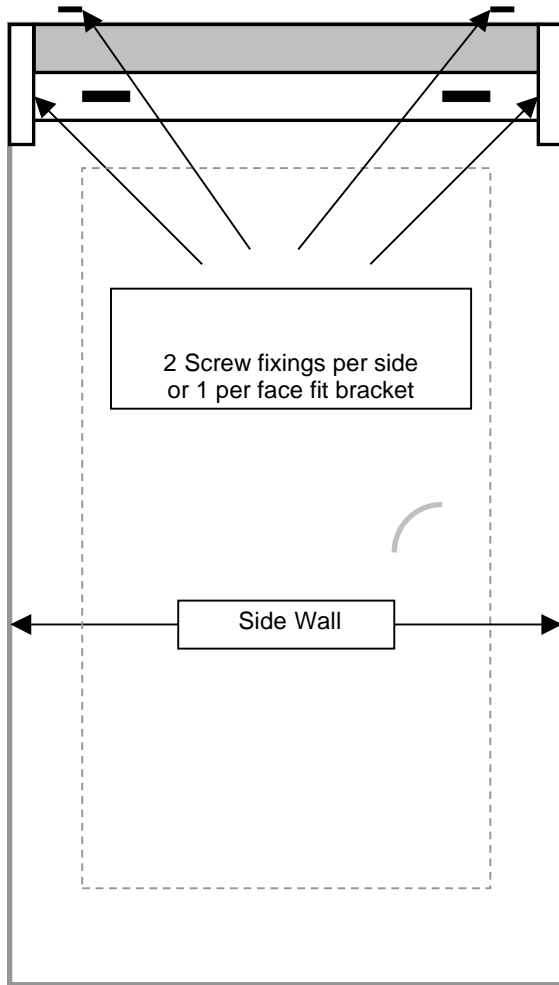

Fitting the Side Guides - Fig 2.

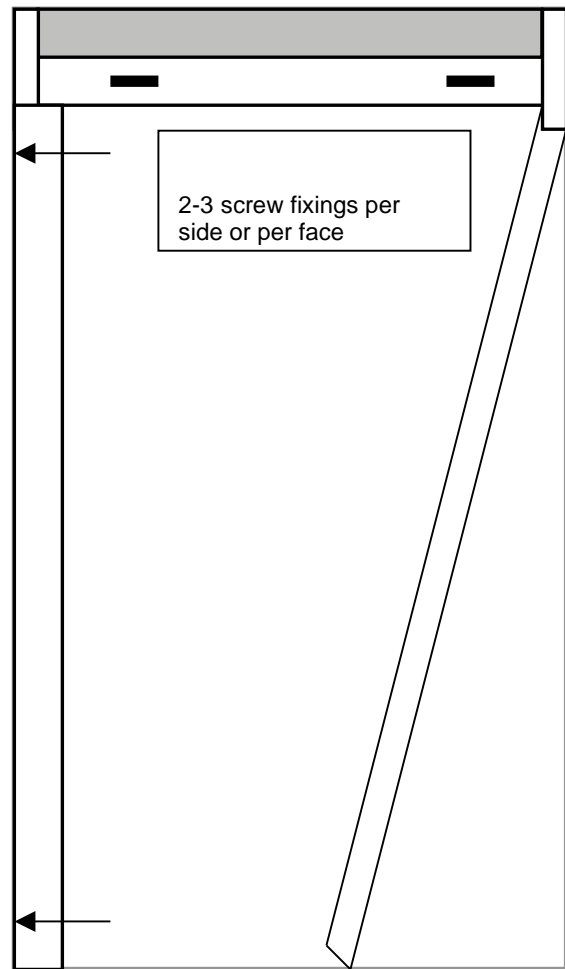

Header Cassette (HC) Fig 1.

1. **Reveal Fit:** Position the HC in the top of the window recess so that it fits between the two side walls and tightly underneath the upper sill. Make sure the screen is far enough in front of the window so that it clears any obstructions when pulled down. Ensure the HC is straight then mark the four screw holes, drill and fix in place using the yellow rawl plugs and No 6 1" screws.
2. **Face Fit:** Slide the face fitting brackets on to the top of the cassette. Position the HC on the top window frame and align left to right to ensure the side guides can be fitted with the correct overlap on either side. Position the face fit brackets then drill (2.5mm drill bit required) and screw them into position.

Side Guides (SG) with locking Mechanism

3. Take one SG and fix a locking mechanism to the bottom at the front. This slides onto the SG and is held in place by a tab. See Fig 3. Note the locking mechanisms are sided

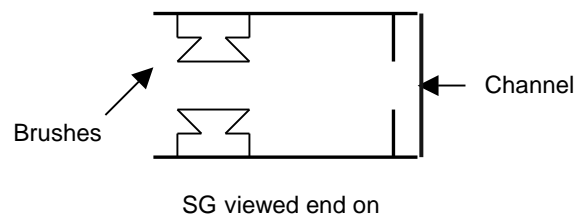
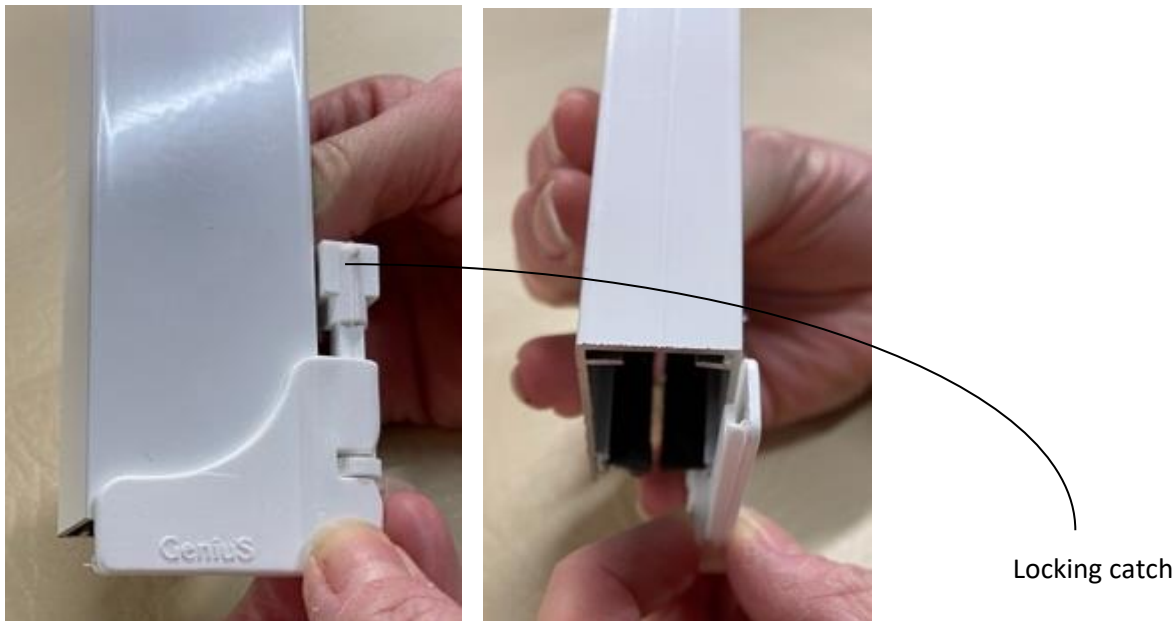

Fig 2. – Reveal Fit

4. Position a SG at an angle as shown on the right in Fig 2 with the channel facing the sidewall and the brushes facing the opposite wall.
5. Locate the channel onto the tab in the HC and move upwards and sideways to the final position as shown on the left in Fig 2.
6. Ensure the SG is vertical then drill and fix to the side wall using the screws provided. Repeat for the second SG.

7. Pull the screen down, locking the handle bar under locking catches to hold it in place. Adjust the locks to ensure the handle bar closes fully against the sill. To release, tilt the handle bar backwards so that it disengages and hold it as it retracts back to the top.

Fig 3. Left hand side guide



Side Guides (SG) Fig 2. – Face Fit

Drill a 2.5mm pilot hole through the front and back face of the guide (with the centre of the hole in the centre of the guide). Now use a 10mm drill bit to drill through the front face of the guide only (the hole needs to allow the head of the screw to pass through to the back of the guide) use the caps provided to cover the hole. A 1.5mm bit is required for the pilot hole into the window frame

Test as per point 7 above.

With Magnetic Closing Channel:

Push the closing channel up and over the bottom of the side guides to ensure a tight fit. The deepest side of the channel should be fitted against the window frame. It can be fixed with bonding tape or screws as supplied. When the screen is pulled down the magnet on the handle bar locks onto the magnet in the closing channel to hold it closed.

